

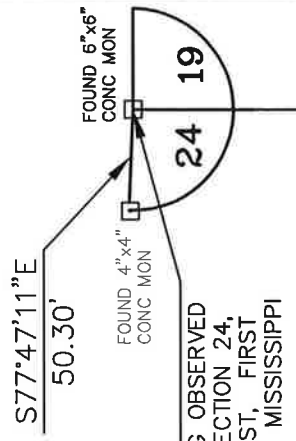

1" = 60'

OCTOBER 10, 2011

BEARINGS BASED ON THE RECORD BEARING OF THE EAST RIGHT-OF-WAY LINE OF U. S. INTERSTATE 59.



L = 16.42'
 R = 10.00'
 CHORD BEARING = N82°10'27"E
 CHORD DISTANCE = 14.64'

S50°46'49"E 24.47'

L = 163.40'
 R = 570.00'
 CHORD BEARING = S42°34'04"E
 CHORD DISTANCE = 162.84'

92 AC.
 SOUTH 4396.31'

ELLEN DRIVE

L = 187.54'
 R = 420.00'
 CHORD BEARING = N22°20'11"E
 CHORD DISTANCE = 185.99'

85
 1.03 AC.

JOAN DRIVE

N09°32'39"E 5.27'

L = 92.37'
 R = 210.00'
 CHORD BEARING = S46°57'23"E
 CHORD DISTANCE = 91.63'

N65°48'15"W 314.52'

84
 1.04 AC.

WEST 1991.34'

POINT-OF-BEGINNING

S12°39'39"W 79.64'

86
 1.48 AC.

PARCEL IS LOCATED IN FLOOD ZONE "X" (OUTSIDE THE 500 YEAR FLOOD PLAIN) AS PER FLOOD INSURANCE RATE MAP NO. 28067C0300E DATED SEPTEMBER 29, 2010.

STATE OF MISSISSIPPI
 COUNTY OF JONES

This is to certify that I have made an accurate survey of the following described property:

A part of the Southwest 1/4 of the Southeast 1/4 of Section 24, Township 7 North, Range 13 West, First Judicial District, Jones County, Mississippi being more particularly described as: Commence at a found 6"x6" concrete monument being observed as the Northeast Corner of Section 24, Township 7 North, Range 13 West, First Judicial District, Jones County, Mississippi; thence run South for 4396.31 feet; thence run West for 1991.34 feet to a point on the South Right-of-Way line of Ellen Drive, said point also known as the Point-of-Beginning; thence run S12°39'39"W for 79.64 feet; thence run N65°48'15"W for 314.52 feet to a point on the East Right-of-Way line of Joan Drive; thence run N09°32'39"E along said East Right-of-Way line for 5.27 feet, said point also being on a curve to the right, having a Radius of 420.00 feet, a Chord Bearing of N22°20'11"E and a Chord Distance of 185.99 feet; thence run Northeasterly along said curve to the right and said East Right-of-Way line for 187.54 feet to a point on a curve to the right, having a Radius of 10.00 feet, a Chord Bearing of N82°10'27"E and a Chord Distance of 14.64 feet; thence run Northeasterly South Right-of-Way line of Ellen Drive; thence run S50°46'49"E along said South Right-of-Way line for 24.47 feet to a point on a curve to the right, having a Radius of 570.00 feet, a Chord Bearing of S42°34'04"E and a Chord Distance of 162.84 feet; thence run Southeasterly along said curve to the right and said South Right-of-Way line for 163.40 feet; thence run S34°21'19"E for 39.35 feet to a point on a curve to the left, having a Radius of 210.00 feet, a Chord Bearing of S46°57'23"E and a Chord Distance of 91.63 feet; thence run Southeasterly along said curve to the left and said South Right-of-Way line for 92.37 feet to the Point-of-Beginning, comprising 1.03 Acres, more or less.

William F. Waits, P.E., R.L.S.
 Civil Engineer No. 12261
 Land Surveyor No. 2639

Flood Zone: X
 Map Number: 28067C0300E



Waits
Engineering
Consultants, INC

41 Carriage Parke Drive
 Purvis, Mississippi 39475
 Phone: (601) 408-3674

Date: 10/10/11
 Scale: 1" = 60'
 Survey Class: "B"
 Project No.: 06-591-85
 Drawn by: K Sauls